

LOCATION MAP N.T.S.

Remaining Portion of Block 1
Padre Island-Corpus Christi Section 18
Vol. 38, Pgs. 69-70, Map
Records of Nueces County, Texas
(Owner: State of Texas)

Lot 1, Block 4
Padre Island-Corpus Christi Section 18
Vol. 57, Pg. 105, Map
Records of Nueces County, Texas

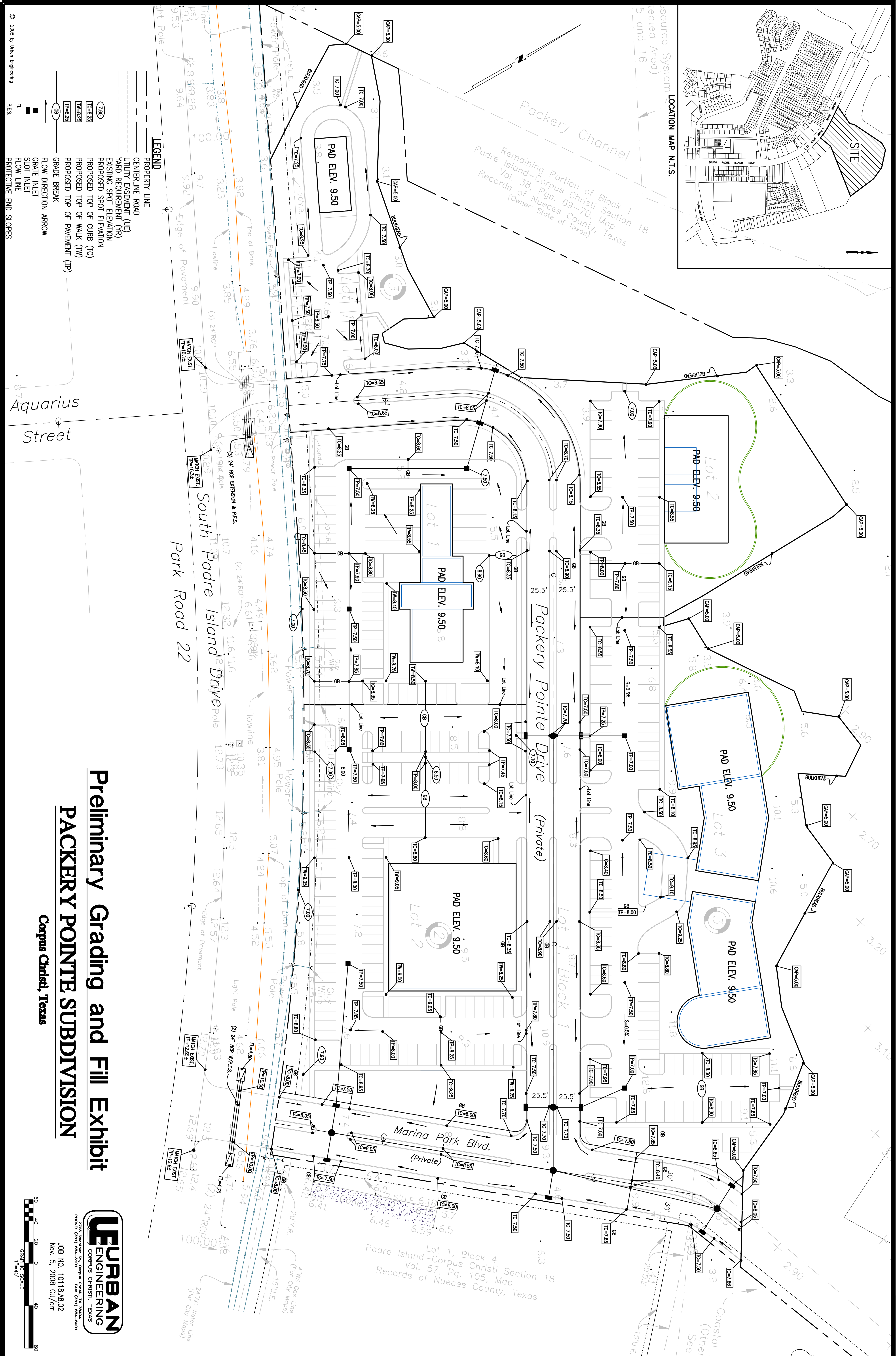

LEGEND

- PROPERTY LINE
- CENTERLINE ROAD
- UTILITY EASEMENT (UE)
- YARD REQUIREMENT (YR)
- EXISTING SPOT ELEVATION
- PROPOSED SPOT ELEVATION
- PROPOSED TOP OF CURB (TC)
- PROPOSED TOP OF PAVEMENT (TP)
- GRADE BREAK
- FLOW DIRECTION ARROW
- GRATE INLET
- SLOT INLET
- FLOW LINE
- PROTECTIVE END SLOPES

Preliminary Grading and Fill Exhibit

PACKERY POINTE SUBDIVISION

Corpus Christi, Texas



2725 Spanglers Rd., Corpus Christi, TX 78404
PHONE: (361) 854-5101 FAX: (361) 854-0001

JOB NO. 101184802
Nov. 5, 2008 CU/crr

