

FOR SUB-LEASE

PRIME OFFICE SPACE

TOWER II

**555 N. CARANCAHUA, SUITE 400
CORPUS CHRISTI, TEXAS 78478
5,255 SF AVAILABLE**



- ▶ The fourth floor is occupied by a large attorney office that can be sub-leased.
- ▶ Building occupies the city block between Leopard, Chaparral adjacent to Nueces County Courthouse.
- ▶ 5 covered garage parking spaces are included with this sub-lease. Additional spaces are available.
- ▶ Located in the heart of the uptown business district.
- ▶ Walking distance to all major hotels, restaurants, and nearby courthouse.
- ▶ Conference room to be shared.

SUITE #400 – 5,255 SF / \$5,880/month (\$1.13/sf) through June 2014
With slight rate escalations annually

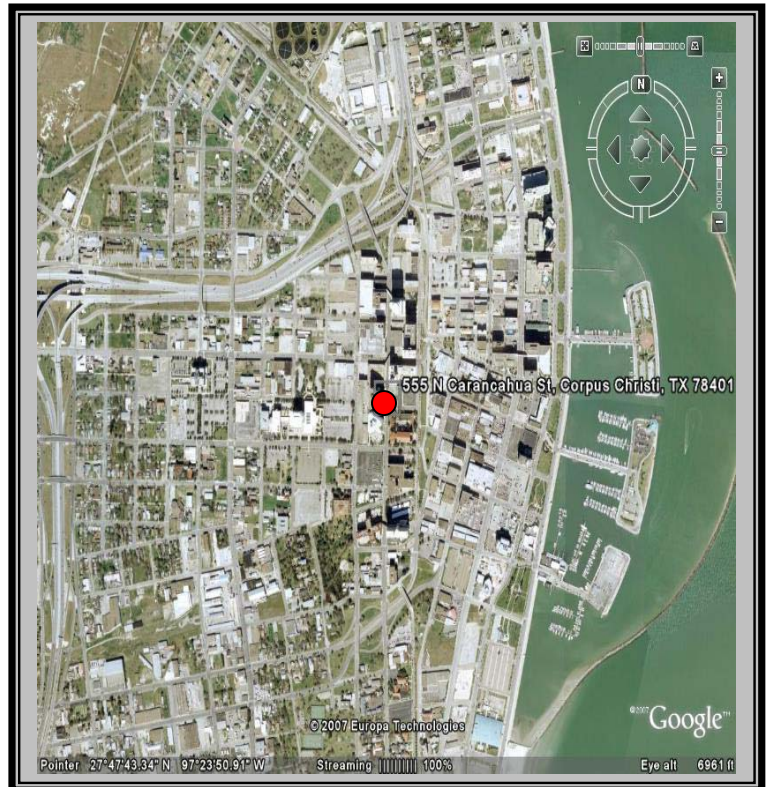
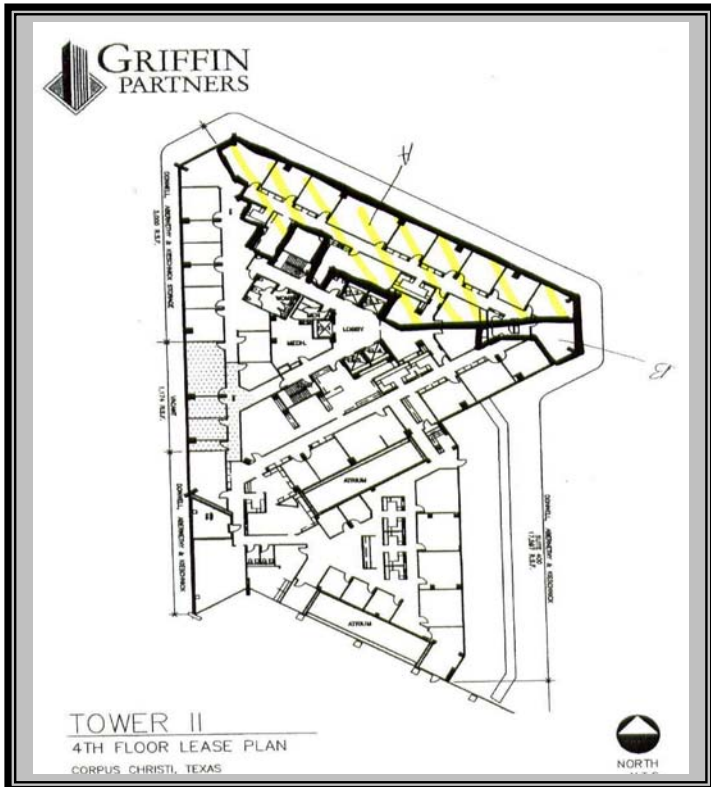

CONTACT: Wayne Lundquist
Cobb, Lundquist & Atnip, Inc. * 700 Everhart Suite F-11, Corpus Christi, Texas 78411
(361) 854-4448 or Wayne@CLArealtors.com

This information has been secured from reliable sources, and although we do not guarantee it, we believe it to be correct. Offering is subject to prior sale, change or withdrawal without notice.